



3 1 1 ☰ C

Devonshire Road, Bexhill-On-Sea, TN40 1AH

£1,200 Per Calendar Month



# Oliver & Bailey

01424 834000 | 01424 533 555

Info@oliverbaileylettings.co.uk  
www.oliverbaileylettings.co.uk

**Entrance hall**

**Living Room**

20'2" x 11'8" (6.17m x 3.57m)

**Kitchen**

11'9" x 8'6" (3.60m x 2.60m)

**Bedroom One**

11'11" x 11'7" (3.64m x 3.55m)

**Bedroom Two**

8'6" x 6'2" (2.6m x 1.9m)

**Bedroom Three**

7'10" x 7'2" (2.4m x 2.2m)

**Shower Room**



**Furnished Options: Unfurnished**

**Council Tax Band: B**

**Available Date: 11th April 2025**

**Oliver  
& Bailey**

---

**BRIGHT APARTMENT IN A POPULAR LOCATION... Call Georgia or Robyn at Oliver & bailey to view this well presented and neutrally decorated three bedroom second floor apartment.**

**Located in the heart of Bexhill Town Centre the property is in a prime position to all local amenities, restaurants, sea front promenade and Main Line Train Station with direct routes to London, Brighton and Ashford International.**

**Accommodation comprises a spacious living room, modern fitted kitchen with integrated oven/hob, shower room, large double bedroom to the front of the property and two smaller single bedrooms to the rear of the property.**

**Further benefits to the property are gas central heating, communal lift within the building and water is charged at £50.00 PCM.**

# FLOORPLAN

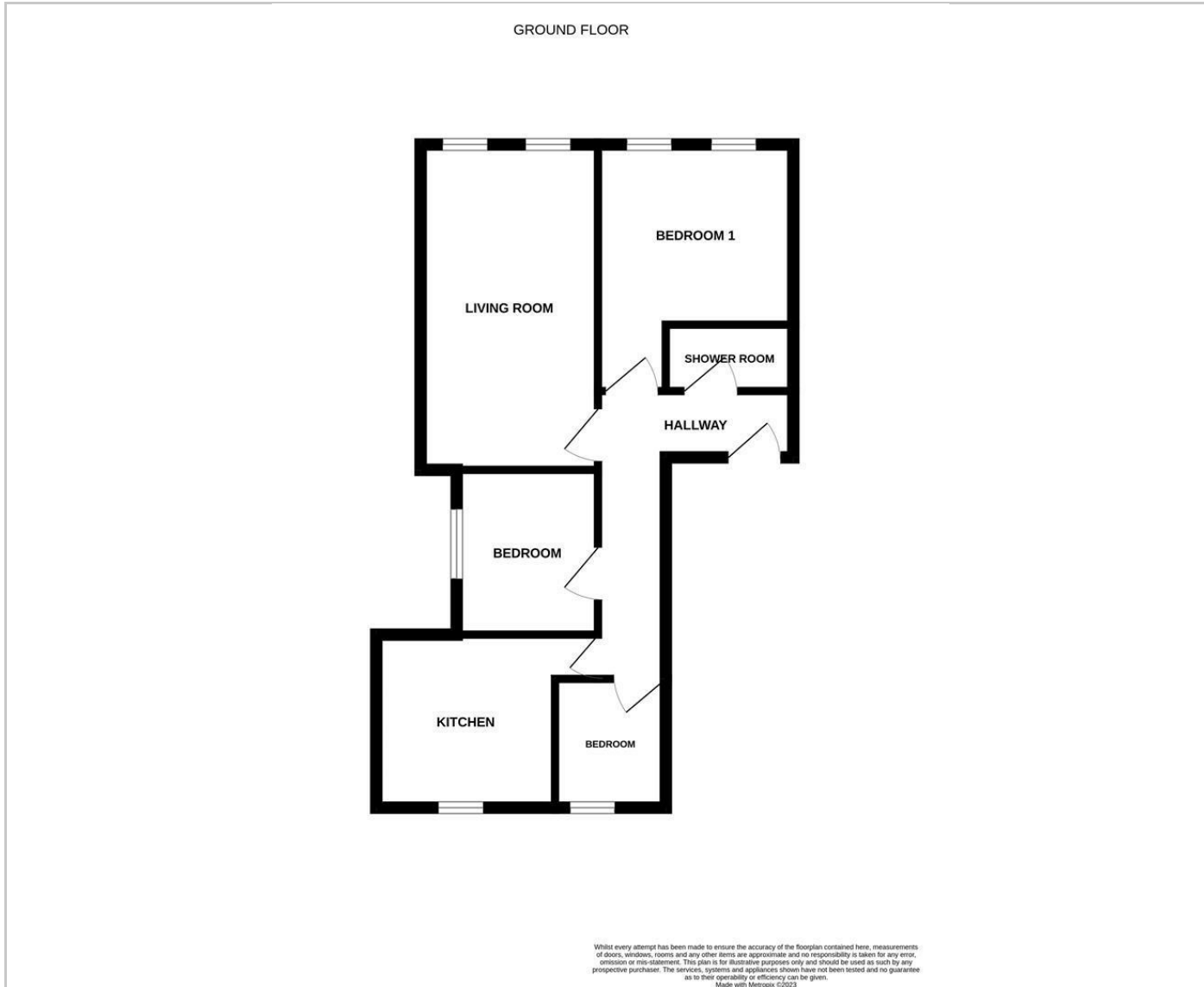

# AREA MAP

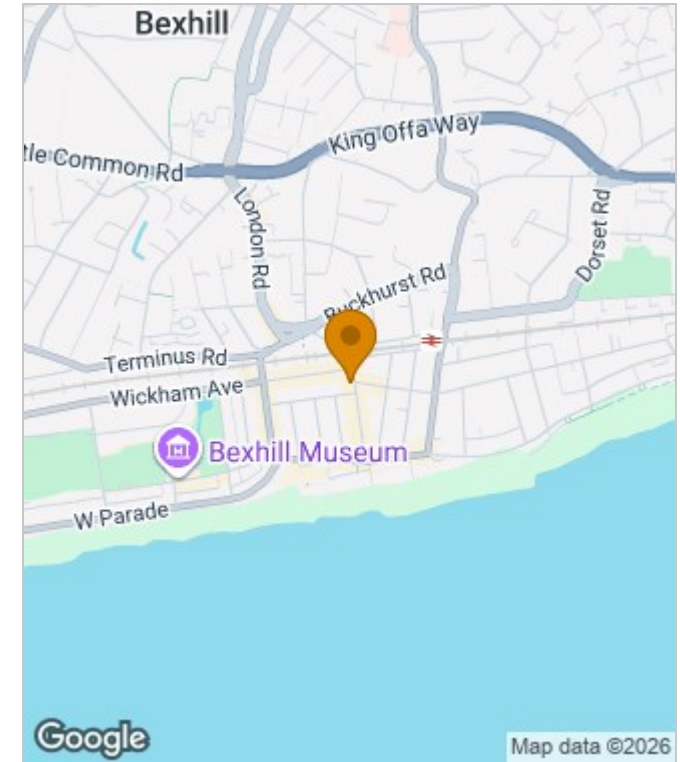

Energy Efficiency Rating		Current	Potential
Very energy efficient - lower running costs			
(92 plus) A			
(81-91) B			
(69-80) C			
(55-68) D			
(39-54) E			
(21-38) F			
(1-20) G			
Not energy efficient - higher running costs			
England & Wales		EU Directive 2002/91/EC	

Environmental Impact (CO <sub>2</sub> ) Rating		Current	Potential
Very environmentally friendly - lower CO <sub>2</sub> emissions			
(92 plus) A			
(81-91) B			
(69-80) C			
(55-68) D			
(39-54) E			
(21-38) F			
(1-20) G			
Not environmentally friendly - higher CO <sub>2</sub> emissions			
England & Wales		EU Directive 2002/91/EC	

These particulars, whilst believed to be accurate are set out as a general outline only for guidance and do not constitute any part of an offer or contract. Intending purchasers should not rely on them as statements of representation of fact, but must satisfy themselves by inspection or otherwise as to their accuracy. No person in this firm's employment has the authority to make or give any representation or warranty in respect of the property.